

**NOTES**

1. ALL DIMENSIONS ARE IN FEET AND INCHES.
2. FINISHES ARE AS SHOWN ON THE DRAWINGS.
3. REFER TO THE SPECIFICATIONS FOR MATERIALS AND METHODS OF CONSTRUCTION.
4. THE CONTRACTOR SHALL BE RESPONSIBLE FOR OBTAINING ALL NECESSARY PERMITS AND APPROVALS.
5. THE CONTRACTOR SHALL MAINTAIN ACCESS TO ALL ADJACENT PROPERTIES AT ALL TIMES.
6. THE CONTRACTOR SHALL PROTECT ALL EXISTING UTILITIES AND STRUCTURES.
7. THE CONTRACTOR SHALL MAINTAIN A SAFE WORKING ENVIRONMENT AT ALL TIMES.
8. THE CONTRACTOR SHALL BE RESPONSIBLE FOR THE PROTECTION OF THE ENVIRONMENT.
9. THE CONTRACTOR SHALL MAINTAIN RECORDS OF ALL WORK DONE.
10. THE CONTRACTOR SHALL BE RESPONSIBLE FOR THE PROTECTION OF ALL PERSONAL PROPERTY.

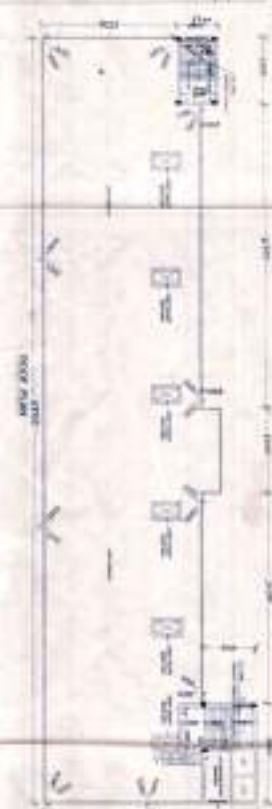
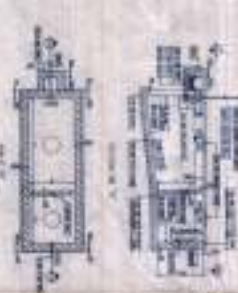

NO.	DESCRIPTION	DATE	BY
1	ISSUED FOR PERMITTING	10/15/2023	J. SMITH
2	ISSUED FOR CONSTRUCTION	11/01/2023	J. SMITH
3	ISSUED FOR AS-BUILT	12/31/2023	J. SMITH

**PROJECT INFORMATION**

PROJECT NO. 2023-001

CLIENT: ABC COMPANY

LOCATION: 123 MAIN ST, NEW YORK, NY 10001

DATE: 10/15/2023

SCALE: AS SHOWN

**DESIGNER INFORMATION**

ARCHITECT: J. SMITH

REGISTERED ARCHITECT

NO. 12345

STATE OF NEW YORK

**CONTRACT INFORMATION**

CONTRACT NO. 2023-001

DATE OF CONTRACT: 10/15/2023

CONTRACT VALUE: \$1,000,000

CONTRACT TYPE: LUMP SUM

NO.	DESCRIPTION	AMOUNT
1	CONSTRUCTION	\$800,000
2	DESIGN	\$100,000
3	PERMITS	\$50,000
4	CONTINGENCY	\$50,000
<b>TOTAL</b>		<b>\$1,000,000</b>

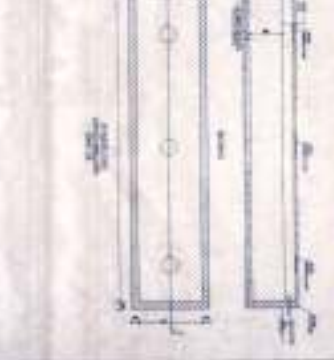



**SCHEDULE OF PARTITIONS, ROOM DIVISIONS, ETC.**

NO.	DESCRIPTION	THICKNESS	FINISH	NOTES
1	1/2" Gypsum Board	1/2"	White	On concrete or masonry
2	1/2" Gypsum Board	1/2"	White	On metal lath and concrete
3	1/2" Gypsum Board	1/2"	White	On metal lath and masonry
4	1/2" Gypsum Board	1/2"	White	On metal lath and brick
5	1/2" Gypsum Board	1/2"	White	On metal lath and concrete block
6	1/2" Gypsum Board	1/2"	White	On metal lath and brick veneer
7	1/2" Gypsum Board	1/2"	White	On metal lath and concrete masonry
8	1/2" Gypsum Board	1/2"	White	On metal lath and brick masonry
9	1/2" Gypsum Board	1/2"	White	On metal lath and concrete block masonry
10	1/2" Gypsum Board	1/2"	White	On metal lath and brick masonry
11	1/2" Gypsum Board	1/2"	White	On metal lath and concrete masonry
12	1/2" Gypsum Board	1/2"	White	On metal lath and brick masonry
13	1/2" Gypsum Board	1/2"	White	On metal lath and concrete masonry
14	1/2" Gypsum Board	1/2"	White	On metal lath and brick masonry
15	1/2" Gypsum Board	1/2"	White	On metal lath and concrete masonry
16	1/2" Gypsum Board	1/2"	White	On metal lath and brick masonry
17	1/2" Gypsum Board	1/2"	White	On metal lath and concrete masonry
18	1/2" Gypsum Board	1/2"	White	On metal lath and brick masonry
19	1/2" Gypsum Board	1/2"	White	On metal lath and concrete masonry
20	1/2" Gypsum Board	1/2"	White	On metal lath and brick masonry

**SCHEDULE OF PARTITIONS, ROOM DIVISIONS, ETC.**

NO.	DESCRIPTION	THICKNESS	FINISH	NOTES
1	1/2" Gypsum Board	1/2"	White	On concrete or masonry
2	1/2" Gypsum Board	1/2"	White	On metal lath and concrete
3	1/2" Gypsum Board	1/2"	White	On metal lath and masonry
4	1/2" Gypsum Board	1/2"	White	On metal lath and brick
5	1/2" Gypsum Board	1/2"	White	On metal lath and concrete block
6	1/2" Gypsum Board	1/2"	White	On metal lath and brick veneer
7	1/2" Gypsum Board	1/2"	White	On metal lath and concrete masonry
8	1/2" Gypsum Board	1/2"	White	On metal lath and brick masonry
9	1/2" Gypsum Board	1/2"	White	On metal lath and concrete block masonry
10	1/2" Gypsum Board	1/2"	White	On metal lath and brick masonry
11	1/2" Gypsum Board	1/2"	White	On metal lath and concrete masonry
12	1/2" Gypsum Board	1/2"	White	On metal lath and brick masonry
13	1/2" Gypsum Board	1/2"	White	On metal lath and concrete masonry
14	1/2" Gypsum Board	1/2"	White	On metal lath and brick masonry
15	1/2" Gypsum Board	1/2"	White	On metal lath and concrete masonry
16	1/2" Gypsum Board	1/2"	White	On metal lath and brick masonry
17	1/2" Gypsum Board	1/2"	White	On metal lath and concrete masonry
18	1/2" Gypsum Board	1/2"	White	On metal lath and brick masonry
19	1/2" Gypsum Board	1/2"	White	On metal lath and concrete masonry
20	1/2" Gypsum Board	1/2"	White	On metal lath and brick masonry

**CLIQUE SCHEDULE**

CLIQUE NO.	CLIQUE DESCRIPTION	CLIQUE AREA	CLIQUE PERIMETER	CLIQUE VOLUME
1	CLIQUE 1	100.00	100.00	100.00
2	CLIQUE 2	150.00	150.00	150.00
3	CLIQUE 3	200.00	200.00	200.00
4	CLIQUE 4	250.00	250.00	250.00
5	CLIQUE 5	300.00	300.00	300.00
6	CLIQUE 6	350.00	350.00	350.00
7	CLIQUE 7	400.00	400.00	400.00
8	CLIQUE 8	450.00	450.00	450.00
9	CLIQUE 9	500.00	500.00	500.00
10	CLIQUE 10	550.00	550.00	550.00
11	CLIQUE 11	600.00	600.00	600.00
12	CLIQUE 12	650.00	650.00	650.00
13	CLIQUE 13	700.00	700.00	700.00
14	CLIQUE 14	750.00	750.00	750.00
15	CLIQUE 15	800.00	800.00	800.00
16	CLIQUE 16	850.00	850.00	850.00
17	CLIQUE 17	900.00	900.00	900.00
18	CLIQUE 18	950.00	950.00	950.00
19	CLIQUE 19	1000.00	1000.00	1000.00
20	CLIQUE 20	1050.00	1050.00	1050.00

**SLAB SCHEDULE**

SLAB NO.	SLAB DESCRIPTION	SLAB AREA	SLAB PERIMETER	SLAB VOLUME
1	SLAB 1	100.00	100.00	100.00
2	SLAB 2	150.00	150.00	150.00
3	SLAB 3	200.00	200.00	200.00
4	SLAB 4	250.00	250.00	250.00
5	SLAB 5	300.00	300.00	300.00
6	SLAB 6	350.00	350.00	350.00
7	SLAB 7	400.00	400.00	400.00
8	SLAB 8	450.00	450.00	450.00
9	SLAB 9	500.00	500.00	500.00
10	SLAB 10	550.00	550.00	550.00
11	SLAB 11	600.00	600.00	600.00
12	SLAB 12	650.00	650.00	650.00
13	SLAB 13	700.00	700.00	700.00
14	SLAB 14	750.00	750.00	750.00
15	SLAB 15	800.00	800.00	800.00
16	SLAB 16	850.00	850.00	850.00
17	SLAB 17	900.00	900.00	900.00
18	SLAB 18	950.00	950.00	950.00
19	SLAB 19	1000.00	1000.00	1000.00
20	SLAB 20	1050.00	1050.00	1050.00

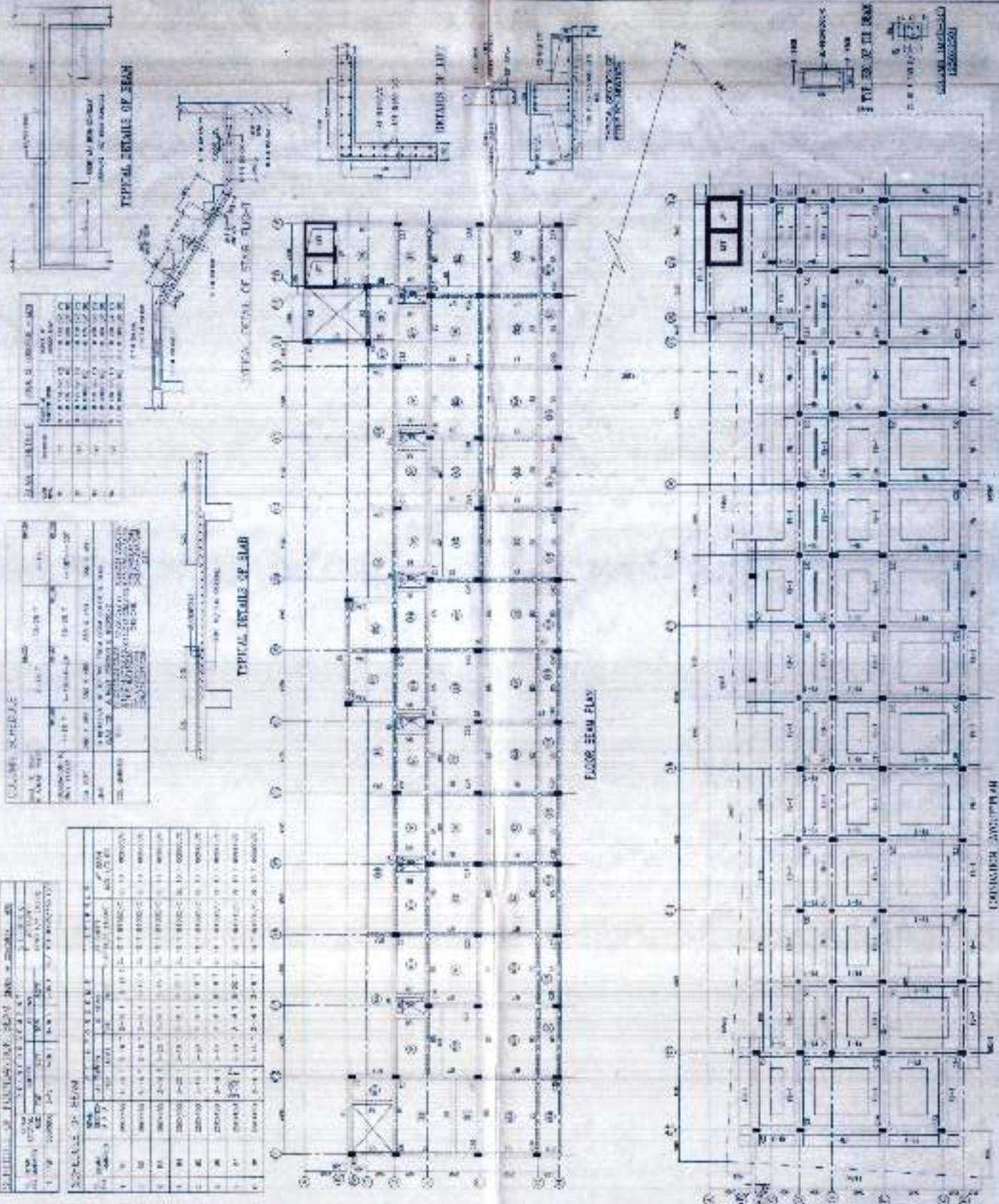

**REVISIONS**

NO.	DESCRIPTION	DATE
1	AS NOTED	10/1/50
2	REVISION 1	10/1/50
3	REVISION 2	10/1/50
4	REVISION 3	10/1/50
5	REVISION 4	10/1/50
6	REVISION 5	10/1/50
7	REVISION 6	10/1/50
8	REVISION 7	10/1/50
9	REVISION 8	10/1/50
10	REVISION 9	10/1/50
11	REVISION 10	10/1/50
12	REVISION 11	10/1/50
13	REVISION 12	10/1/50
14	REVISION 13	10/1/50
15	REVISION 14	10/1/50
16	REVISION 15	10/1/50
17	REVISION 16	10/1/50
18	REVISION 17	10/1/50
19	REVISION 18	10/1/50
20	REVISION 19	10/1/50

**NOTES**

1. ALL CONCRETE SHALL BE 3000 PSI STRENGTH.
2. ALL REINFORCEMENT SHALL BE #4 BARS UNLESS OTHERWISE NOTED.
3. ALL JOISTS SHALL BE 12" DEEP UNLESS OTHERWISE NOTED.
4. ALL BEAMS SHALL BE 12" DEEP UNLESS OTHERWISE NOTED.
5. ALL SLABS SHALL BE 4" THICK UNLESS OTHERWISE NOTED.
6. ALL WALLS SHALL BE 8" THICK UNLESS OTHERWISE NOTED.
7. ALL PARTITIONS SHALL BE 1/2" GYPSUM BOARD ON METAL LATH UNLESS OTHERWISE NOTED.
8. ALL FLOORS SHALL BE 1/2" GYPSUM BOARD ON METAL LATH UNLESS OTHERWISE NOTED.
9. ALL CEILING SHALL BE 1/2" GYPSUM BOARD ON METAL LATH UNLESS OTHERWISE NOTED.
10. ALL ROOF SHALL BE 4" CONCRETE ON 12" JOISTS UNLESS OTHERWISE NOTED.
11. ALL EXTERIOR WALLS SHALL BE 8" THICK UNLESS OTHERWISE NOTED.
12. ALL EXTERIOR ROOF SHALL BE 4" CONCRETE ON 12" JOISTS UNLESS OTHERWISE NOTED.
13. ALL INTERIOR WALLS SHALL BE 8" THICK UNLESS OTHERWISE NOTED.
14. ALL INTERIOR ROOF SHALL BE 4" CONCRETE ON 12" JOISTS UNLESS OTHERWISE NOTED.
15. ALL FOUNDATION SHALL BE 12" CONCRETE ON 12" JOISTS UNLESS OTHERWISE NOTED.
16. ALL STRUCTURAL STEEL SHALL BE A36 UNLESS OTHERWISE NOTED.
17. ALL STRUCTURAL WELDS SHALL BE E70 UNLESS OTHERWISE NOTED.
18. ALL STRUCTURAL BOLTS SHALL BE A325 UNLESS OTHERWISE NOTED.
19. ALL STRUCTURAL NUTS SHALL BE A325 UNLESS OTHERWISE NOTED.
20. ALL STRUCTURAL PLATES SHALL BE A36 UNLESS OTHERWISE NOTED.

**GENERAL NOTES**

1. ALL DIMENSIONS SHALL BE IN FEET AND INCHES UNLESS OTHERWISE NOTED.

2. ALL DIMENSIONS SHALL BE TO THE FACE UNLESS OTHERWISE NOTED.

3. ALL DIMENSIONS SHALL BE TO THE CENTER UNLESS OTHERWISE NOTED.

4. ALL DIMENSIONS SHALL BE TO THE SURFACE UNLESS OTHERWISE NOTED.

5. ALL DIMENSIONS SHALL BE TO THE MIDDLE UNLESS OTHERWISE NOTED.

6. ALL DIMENSIONS SHALL BE TO THE EDGE UNLESS OTHERWISE NOTED.

7. ALL DIMENSIONS SHALL BE TO THE CORNER UNLESS OTHERWISE NOTED.

8. ALL DIMENSIONS SHALL BE TO THE CENTERLINE UNLESS OTHERWISE NOTED.

9. ALL DIMENSIONS SHALL BE TO THE MIDLINE UNLESS OTHERWISE NOTED.

10. ALL DIMENSIONS SHALL BE TO THE CENTERLINE UNLESS OTHERWISE NOTED.

11. ALL DIMENSIONS SHALL BE TO THE MIDLINE UNLESS OTHERWISE NOTED.

12. ALL DIMENSIONS SHALL BE TO THE CENTERLINE UNLESS OTHERWISE NOTED.

13. ALL DIMENSIONS SHALL BE TO THE MIDLINE UNLESS OTHERWISE NOTED.

14. ALL DIMENSIONS SHALL BE TO THE CENTERLINE UNLESS OTHERWISE NOTED.

15. ALL DIMENSIONS SHALL BE TO THE MIDLINE UNLESS OTHERWISE NOTED.

16. ALL DIMENSIONS SHALL BE TO THE CENTERLINE UNLESS OTHERWISE NOTED.

17. ALL DIMENSIONS SHALL BE TO THE MIDLINE UNLESS OTHERWISE NOTED.

18. ALL DIMENSIONS SHALL BE TO THE CENTERLINE UNLESS OTHERWISE NOTED.

19. ALL DIMENSIONS SHALL BE TO THE MIDLINE UNLESS OTHERWISE NOTED.

20. ALL DIMENSIONS SHALL BE TO THE CENTERLINE UNLESS OTHERWISE NOTED.



**SCHEDULE OF FOUNDATION BEAM AND COLUMN**

NO.	SECTION	LENGTH	PERIMETER	AREA	WEIGHT
1	1-1	10.00	10.00	10.00	10.00
2	2-2	10.00	10.00	10.00	10.00
3	3-3	10.00	10.00	10.00	10.00
4	4-4	10.00	10.00	10.00	10.00
5	5-5	10.00	10.00	10.00	10.00
6	6-6	10.00	10.00	10.00	10.00
7	7-7	10.00	10.00	10.00	10.00
8	8-8	10.00	10.00	10.00	10.00
9	9-9	10.00	10.00	10.00	10.00
10	10-10	10.00	10.00	10.00	10.00

**SCHEDULE OF BEAM**

NO.	SECTION	LENGTH	PERIMETER	AREA	WEIGHT
1	1-1	10.00	10.00	10.00	10.00
2	2-2	10.00	10.00	10.00	10.00
3	3-3	10.00	10.00	10.00	10.00
4	4-4	10.00	10.00	10.00	10.00
5	5-5	10.00	10.00	10.00	10.00
6	6-6	10.00	10.00	10.00	10.00
7	7-7	10.00	10.00	10.00	10.00
8	8-8	10.00	10.00	10.00	10.00
9	9-9	10.00	10.00	10.00	10.00
10	10-10	10.00	10.00	10.00	10.00

**TABLES CONTINUED**

NO.	SECTION	LENGTH	PERIMETER	AREA	WEIGHT
1	1-1	10.00	10.00	10.00	10.00
2	2-2	10.00	10.00	10.00	10.00
3	3-3	10.00	10.00	10.00	10.00
4	4-4	10.00	10.00	10.00	10.00
5	5-5	10.00	10.00	10.00	10.00
6	6-6	10.00	10.00	10.00	10.00
7	7-7	10.00	10.00	10.00	10.00
8	8-8	10.00	10.00	10.00	10.00
9	9-9	10.00	10.00	10.00	10.00
10	10-10	10.00	10.00	10.00	10.00

**SLAB SCHEDULE**

NO.	SECTION	LENGTH	PERIMETER	AREA	WEIGHT
1	1-1	10.00	10.00	10.00	10.00
2	2-2	10.00	10.00	10.00	10.00
3	3-3	10.00	10.00	10.00	10.00
4	4-4	10.00	10.00	10.00	10.00
5	5-5	10.00	10.00	10.00	10.00
6	6-6	10.00	10.00	10.00	10.00
7	7-7	10.00	10.00	10.00	10.00
8	8-8	10.00	10.00	10.00	10.00
9	9-9	10.00	10.00	10.00	10.00
10	10-10	10.00	10.00	10.00	10.00

**TYPICAL DETAILS OF BEAM**



**TYPICAL DETAILS OF SLAB**



**TYPICAL DETAIL OF CORNER JOINT**



**DETAILS OF LIFT**

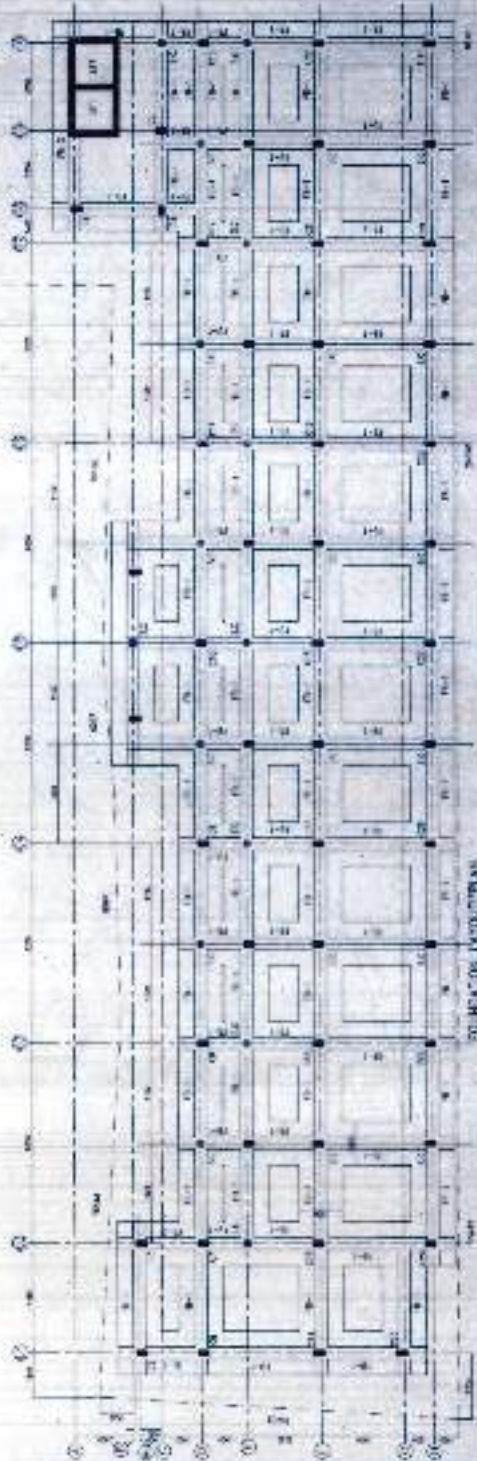

**CLOSE BEAM PLAN**

**SECTION OF COLUMN**

**NOTES AND SPECIFICATIONS**

1. ALL WORK TO BE DONE ACCORDING TO THE LATEST EDITIONS OF THE SPECIFICATIONS FOR STRUCTURAL STEEL AND CONCRETE.
2. ALL WORK TO BE DONE ACCORDING TO THE LATEST EDITIONS OF THE SPECIFICATIONS FOR STRUCTURAL STEEL AND CONCRETE.
3. ALL WORK TO BE DONE ACCORDING TO THE LATEST EDITIONS OF THE SPECIFICATIONS FOR STRUCTURAL STEEL AND CONCRETE.
4. ALL WORK TO BE DONE ACCORDING TO THE LATEST EDITIONS OF THE SPECIFICATIONS FOR STRUCTURAL STEEL AND CONCRETE.
5. ALL WORK TO BE DONE ACCORDING TO THE LATEST EDITIONS OF THE SPECIFICATIONS FOR STRUCTURAL STEEL AND CONCRETE.
6. ALL WORK TO BE DONE ACCORDING TO THE LATEST EDITIONS OF THE SPECIFICATIONS FOR STRUCTURAL STEEL AND CONCRETE.
7. ALL WORK TO BE DONE ACCORDING TO THE LATEST EDITIONS OF THE SPECIFICATIONS FOR STRUCTURAL STEEL AND CONCRETE.
8. ALL WORK TO BE DONE ACCORDING TO THE LATEST EDITIONS OF THE SPECIFICATIONS FOR STRUCTURAL STEEL AND CONCRETE.
9. ALL WORK TO BE DONE ACCORDING TO THE LATEST EDITIONS OF THE SPECIFICATIONS FOR STRUCTURAL STEEL AND CONCRETE.
10. ALL WORK TO BE DONE ACCORDING TO THE LATEST EDITIONS OF THE SPECIFICATIONS FOR STRUCTURAL STEEL AND CONCRETE.

**APPROVED FOR ME**  
**ARCHITECT**  
**DATE**

**EXPLANATION**  
 1. ALL WORK TO BE DONE ACCORDING TO THE LATEST EDITIONS OF THE SPECIFICATIONS FOR STRUCTURAL STEEL AND CONCRETE.

*Handwritten notes and signatures.*

**PREPARED BY**

*Handwritten signature.*

**PROJECT**  
**PROFESSIONAL ENGINEER**  
**REGISTERED IN THE STATE OF TEXAS**  
**NO. 12345**

**REVISIONS**

NO.	DATE	DESCRIPTION
1	10/1/19	ISSUED FOR PERMITS
2	10/15/19	REVISED PER COMMENTS
3	10/30/19	REVISED PER COMMENTS
4	11/10/19	REVISED PER COMMENTS
5	11/20/19	REVISED PER COMMENTS